

P R O D U C T
CATALOGUE



SERIES - 40

WAFER TYPE CHECK VALVE



STAFFORD CHECK VALVE MODEL SERIES - 40 ARE PRIMARILY SINGLE PLATE SWING CHECK VALVE WITH A SHORT PATTERN BODY CONFORMING TO THE API 6D AND ANSI B16.10 FACE TO FACE DIMENSIONS.

THE VALVE HAS A SIMPLE BUT ROBUST CONSTRUCTION WITH RELIABILITY. THE LOW INERTIA DISC DESIGN ENABLES THE VALVE TO OPEN AND CLOSE WITH A VERY LOW DIFFERENTIAL PRESSURES

THE PRESSURE DROP ACROSS THE VALVE IN FULLY OPEN CONDITION IS RELATIVELY LOW AND MAKES THEM IDEAL FOR PUMP DISCHARGE DUTIES. THE ECCENTRIC DISC SHAFT IN COMBINATION WITH THE DISC SEAT GUARANTEES A POSITIVE SHUT OFF OF THE RETURNING MEDIA.

THE SHORT FACE TO FACE DIMENSIONS AND LOW WEIGHT ALLOWS A SIMPLE SPACE SAVING INSTALLATION BETWEEN THE MATING COMPANION FLANGES.

THE VALVES ARE SUITABLE FOR MOUNTING BETWEEN WELD NECK OR SLIP ON TYPE COMPANION FLANGES OF DIFFERENT STANDARDS. THE NEED FOR FLANGE GASKETS DURING INSTALLATION IS TOTALLY ELIMINATED IN THE CASE OF SERIES - 40 CHECK VALVES DUE TO THE IN-BUILT FACE SEALING “O” RINGS PROVIDED ON THE SEALING FACE, HOWEVER GASKETS ARE RECOMMENDED WHILE INSTALLING.

CONFORMITY TO CODES AND STANDARDS

VALVE TESTING	:	API 598 / ANSI B 16
DESIGN & FACE TO FACE DIMENSIONS	:	API 6D / ANSI B 16
FLANGE STANDARD CONFORMITY	:	ANSI #150, EN PN10 & PN16, BS10 TABLE D&E

TECHNICAL SPECIFICATIONS

1. VALVE TYPE	:	SELF ACTING NON - RETURN VALVE
2. DESCRIPTION	:	SINGLE PLATE WAFER TYPE SWING CHECK VALVE
3. BODY PATTERN	:	SHORT PATTERN WAFER TYPE
4. DISC TYPE	:	WITH INTEGRAL HINGE PIN
5. MODEL NOMENCLATURE	:	SERIES - 40 VALVES ARE PROVIDED WITH RUBBER O - RING SEAT AND FACE SEALING WITH SERRATED CONTACT FACES
6. SIZE RANGE	:	25 NB TO 1000 NB
7. PRESSURE RATING	:	PN 16 (MAX)
8. OPERATING TEMP RANGE	:	-25 C TO 200 C (DEPENDING ON MOC)
9. SEAT LEAKAGE	:	ZERO LEAK / TIGHT SHUT OFF

STANDARD MATERIAL OF CONSTRUCTION (MOC)

BODY	:	CI / SGI / WCB / CF8 / CF8M / CS / IS 2062
DISC	:	CI / SGI / WCN / CF8 / CF8M
SEAT	:	EPDM / NITRILE / VITON / NEOPRENE / HYPALON

ENGINEERING

DIMENSIONS IN (MM) SERIES - 40 (SIZE 2" - 6")

Valve size	A	B	C				
			PN 10	PN 16	BS10D	BS10E	ANSI#150
25	14	16	72	72	69	69	64
40	22	19	93	93	86	86	86
50	30	19	108	108	97	97	104
65	40	19	128	128	110	110	123
80	52	19	143	143	129	129	136
100	71	19	163	163	161	161	174
125	93	19	193	193	193	193	196
150	114	19	219	219	218	215	221

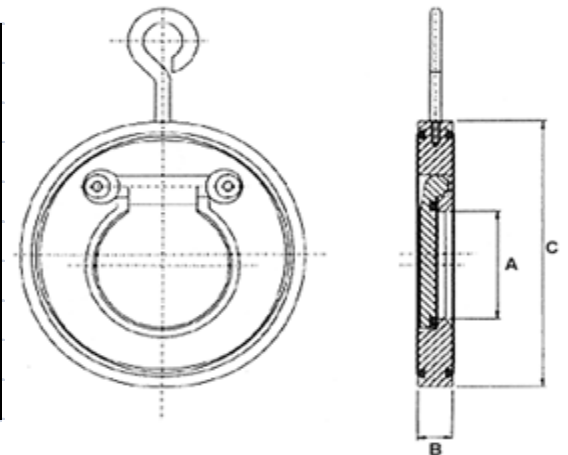

DIMENSIONS IN (MM) SERIES - 40 (SIZE 8" - 24")

Valve size	A	B	C				
			PN 10	PN 16	BS10D	BS10E	ANSI#150
200	157	28.5	274	274	274	272	278
250	195	28.5	329	329	335	335	339
300	230	38	379	385	385	383	409
350	270	44.5	438	444	446	446	449
400	310	51	489	496	496	496	512
450	360	60.5	538	555	559	559	545
500	406	63.5	593	616	616	616	605
600	490	70	695	733	727	724	714

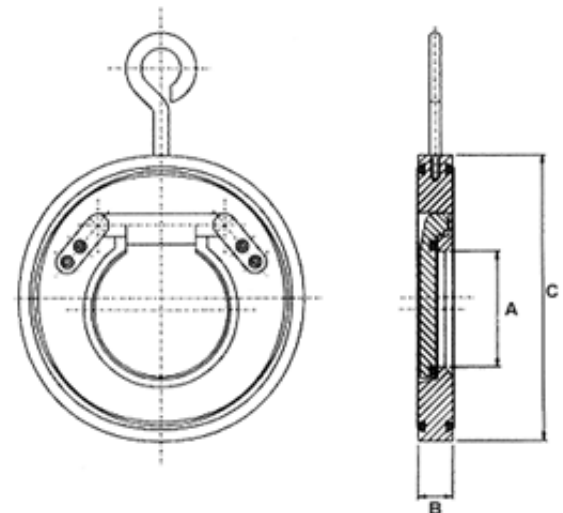

* VALVE SIZE ABOVE 24" CAN BE SUPPLIED AS PER CUSTOMER REQUIREMENTS

KEY FEATURES

1. SERIES - 40 CHECK VALVES ARE HAVING LOW FACE TO FACE DIMENSIONS HENCE SPACE REQUIRED FOR MOUNTING IS LESS WHEN COMPARED WITH NORMAL CONVENTIONAL VALVES.
2. TOTAL WEIGHT OF SERIES - 40 CHECK VALVES IS 16 - 17% LESS THAN THE NORMAL CONVENTIONAL VALVES.
3. SHORT WAFER BODY ENABLES MOUNTING WITH SHORTER FASTENERS WHEN COMPARED WITH STANDARD FLANGED SWING CHECK VALVES.
4. SERIES - 40 CHECK VALVES ARE EASY TO HANDLE / PACK / TRANSPORT / INSTALL AND MAINTAIN.
5. THESE VALVES ARE USER FRIENDLY DUE TO ITS SIMPLE DESIGN CONSTRUCTION AND PROVIDES TROUBLE FREE MAINTENANCE AS THE NUMBER OF PARTS INVOLVED IS LESS.
6. SERIES - 40 CHECK VALVES ARE EASY TO INSTALL AS THE OUTSIDE DIAMETER IS CONTROLLED, WHICH ENABLES SELF CENTERING IN PIPELINE.

QUALITY CERTIFICATIONS

ISO 9001 : 2015



AVANT - GARDE



APPLICATIONS

STAFFORD SERIES - 40 WAFER TYPE CHECK VALVES ARE EXTREMELY ADAPTABLE AND HAVE NUMEROUS APPLICATION POSSIBILITIES, INCLUDING:

- * WATER TREATMENT PLANT
- * WASTE EFFLUENT PLANT
- * BALANCE OF PLANTS
- * COOLING WATER PLANTS
- * CHEMICAL INDUSTRY
- * SUGAR INDUSTRY
- * HVAC PLANTS
- * OIL & GAS PLANTS
- * PAPER INDUSTRY
- * POWER PLANTS
- * DESALINATION PLANTS
- * METALLURGY PLANTS

ALL STATEMENTS, TECHNICAL INFORMATIONS AND RECOMMENDATIONS IN THE BULLETIN ARE FOR GENERAL USE ONLY. STAFFORD IS NOT RESPONSIBLE FOR SUITABILITY OR COMPATIBILITY OF THESE PRODUCTS IN RELATION TO SYSTEM REQUIREMENTS. CONSULT STAFFORD DISTRIBUTORS OR FACTORY FOR THE SPECIFIC REQUIREMENTS AND MATERIAL SELECTION FOR YOUR INTENDED APPLICATION. STAFFORD RESERVES THE RIGHT TO CHANGE OR MODIFY THE PRODUCT DESIGN OR PRODUCT WITHOUT PRIOR NOTICE.

Distributor

STAFFORD CONTROLS LIMITED

Plot No: 319, SIDCO Industrial Estate,
Ambattur, Chennai - 600 098, INDIA.
Phone : +91 44 4207 7741 / 2624 1719
Telefax : +91 44 2624 8319
Email : sales@staffordvalves.com
Website : www.staffordvalves.com
www.staffordcontrols.com